

# WIDE BAND HIGH POWER MIS-MATCHED TERMINATION --- RFMWST50GB

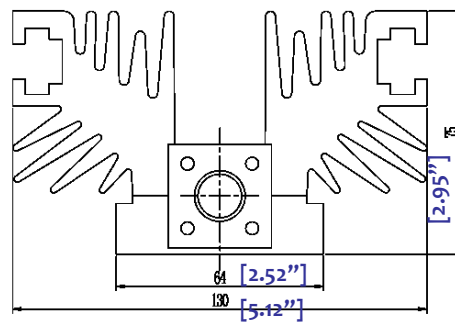

1.0 Mechanical Specifications	
1.1	<b>Coaxial Connector</b> N or 7/16 (Male or Female)
1.2	<b>Size</b> 90 X 130 X 75mm 3.54" X 5.12" X 2.95"
1.3	<b>Weight</b> 1.27kg or 0.39kg
1.4	<b>External Body Finish</b> Body painted with gray/black epoxy enamel

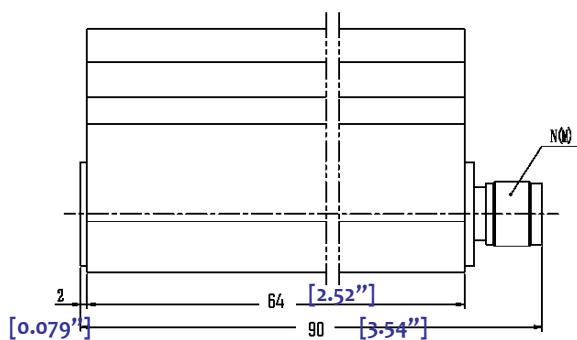
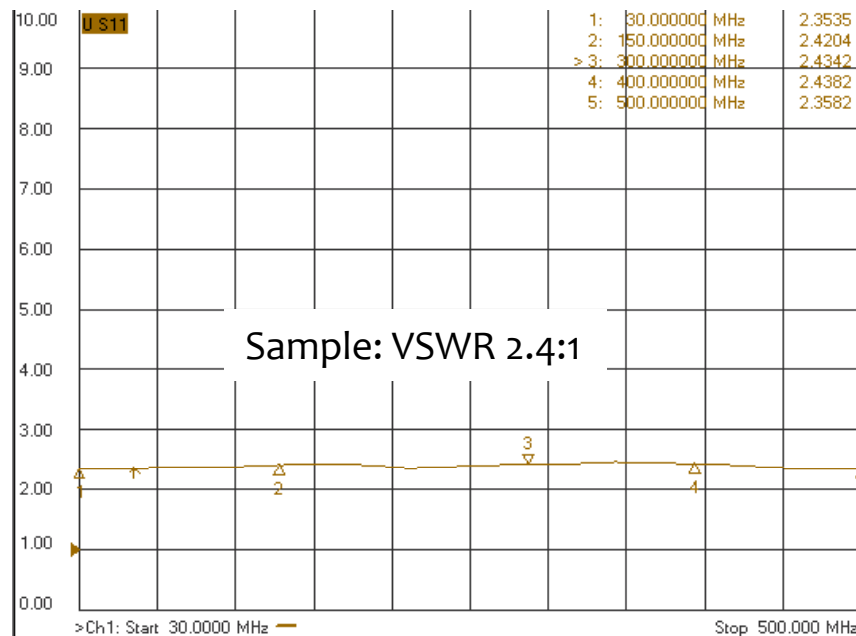

2.0 Environment specifications	
2.1	<b>Operation Temp.</b> -40°C~+85°C
2.2	<b>Storage Temp.</b> -55°C~+125°C
2.3	<b>Altitude</b> 4500 ft
2.4	<b>Vibration</b> 10g rms (15 degree 2KHz)
2.5	<b>Humidity</b> 100% RH at 35c, 95%RH at 40 deg c
2.6	<b>Shock</b> 20G for 11msec
2.7	<b>Cooling</b> FAN required for long time operation

3.0 Electrical Specifications				
PN	Frequency (GHz)	VSWR (max.)	Power (CW)	Peak Power (KW)
RFMWST50GB	0.5-0.8GHz	(1-6)+/-7%	50	5KW

PAGE 1 OF 1	DATE Sep 2 <sup>nd</sup> 2006
<small>PROPRIETARY INFORMATION THE INFORMATION CONTAINED IN THIS DOCUMENT IS THE PROPERTY OF RF-LAMBDA EXCEPT AS SPECIFICALLY AUTHORIZED IN WRITING BY RF-LAMBDA. THE HOLDER OF THIS DOCUMENT SHALL KEEP ALL INFORMATION CONTAINED HEREIN CONFIDENTIAL AND SHALL PROTECT SAME IN THE WHOLE OR IN PART FROM DISCLOSURE AND DISSEMINATION OF ALL THIRD PARTIES AND SHALL USE SAME FOR OPERATING AND MAINTENANCE PURPOSES ONLY</small>	DESIGN RFPG  RF-LAMBDA RFPG  CAD MODEL REVISION 10 ASSEMBLY REVISION VS2 ASSEMBLY NAME RFLVR07 DRAWING NUMBER 005-A
<b>RFMWST50GB HIGH POWER MIS- MATCHED TERMINATION</b>	
www.rflambda.com	
<b>RF-LAMBDA</b>	SIZE IT SHEETS 1 OF 1